

Approved as Noted  
Jeremy Jerden, EIT  
August 15, 2018

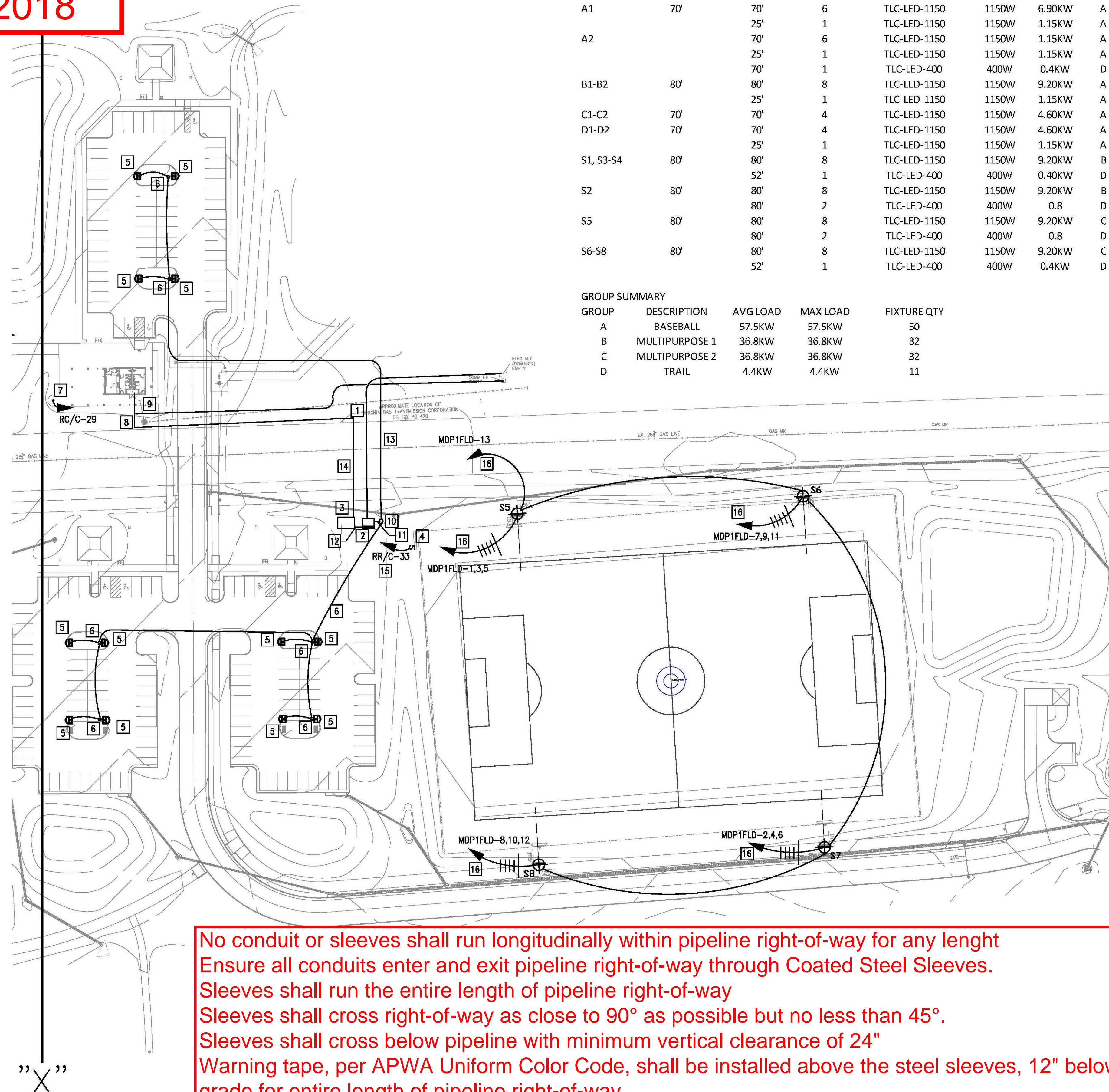

No conduit or sleeves shall run longitudinally within pipeline right-of-way for any length  
Ensure all conduits enter and exit pipeline right-of-way through Coated Steel Sleeves.  
Sleeves shall run the entire length of pipeline right-of-way  
Sleeves shall cross right-of-way as close to 90° as possible but no less than 45°.  
Sleeves shall cross below pipeline with minimum vertical clearance of 24"  
Warning tape, per APWA Uniform Color Code, shall be installed above the steel sleeves, 12" below grade for entire length of pipeline right-of-way  
Sleeves shall be marked with the appropriate signage at boundary edges of pipeline right-of-way

**SITE PLAN—ELECTRICAL**  
SCALE: 1" = 50'-0"

## PLAN NOTES

- \* ALL CONDUITS SHALL BE PVC SCHEDULE 40, MINIMUM 3/4" BELOW GRADE UNLESS OTHERWISE NOTED OR INDICATED.
  - \* VERIFY POLE LOCATIONS AND POLE BASE FOUNDATION DETAILS WITH MUSCO PRIOR TO ROUGH-IN.
  - \* MAKE ALL FINAL CONNECTIONS TO POLE MOUNTED MUSCO CONTROLS. COORDINATE FINAL CONNECTIONS WITH MUSCO.
- 1 PROVIDE 2-6"EC WITH PULL STRING FROM NEW PAD LOCATION TO EMPTY ELECTRIC VAULT. PROVIDE COATED STEEL SLEEVE FOR ROUTING CONDUITS UNDER GAS PIPELINE.
  - 2 PROVIDE NEW PAD FOR POWER COMPANY TRANSFORMER. PAD SHALL BE AS REQUIRED BY POWER COMPANY.
  - 3 PROVIDE NEW 12' X 6' X 8' TALL ENCLOSURE TO HOUSE POWER COMPANY CT CABINET, METER AND DISTRIBUTION AND CONTROL PANELS. ENCLOSURE SHALL BE AS MANUFACTURED BY LITTLE BUILDING, INC. EXTERIOR FINISH SHALL BE WASTE MANAGEMENT GREEN.
  - 4 PROVIDE JB WITH DISCONNECT FOR SERVING NEW SCOREBOARD. COORDINATE LOCATION AND FINAL CONNECTION WITH INSTALLER PRIOR TO ROUGH-IN. 120V, 16. PROVIDE 20A, 1P HP RATED SNAP SWITCH WITH WP ENCLOSURE.
  - 5 SITE LIGHTS TO BE PROVIDED AND INSTALLED BY POWER COMPANY. PROVIDE 2"EC WITH PULL STRING TO PULL BOX AND FROM PULL BOX TO LOCATION AS DIRECTED BY LIGHT FIXTURE INSTALLER.
  - 6 PROVIDE 24" X 36" WP PULL BOX WITH COVER.
  - 7 NEW FLAGPOLE. PROVIDE NEW FLAGPOLE MOUNTED LIGHT. NEW LIGHT SHALL BE AS MANUFACTURED BY AMERICAN BEACON FLAGPOLE 60 LED WHT SILVER FINISH OR APPROVED EQUAL AS MANUFACTURED BY EAGLE MOUNTAIN FLAG.
  - 8 PROPOSED ROUTING OF CONDUIT SERVING CONCESSION/RESTROOM ELECTRICAL SERVICE.
  - 9 PROVIDE 2-4"EC (ONE WITH INTERDUCT) WITH PULL STRING FOR TELECOMM SERVICE. CAP AND PROVIDE GROUND MARKER NEAR CONCESSION STAND FOR FUTURE USE. ROUTE CONDUIT MINIMUM 24" BELOW GRADE TO UTILITY COMMUNICATION BOX.
  - 10 POWER COMPANY 1Ø TRANSFORMER FOR SERVING PARKING LOT LIGHT FIXTURES.
  - 11 PROVIDE 2-4"EC WITH PULL STRING FROM TRANSFORMER PAD TO TRANSFORMER PAD.
  - 12 PROVIDE 4-4"EC WITH PULL STRING FROM POWER COMPANY TRANSFORMER TO CT CABINET FOR POWER COMPANY SECONDARY CONDUCTORS.
  - 13 PROVIDE 1-4" COATED STEEL CONDUIT SLEEVE CROSSING PIPELINE FOR ROUTING 2"EC SERVING STREET LIGHTS TO POWER COMPANY TRANSFORMER. MAINTAIN MINIMUM 24" VERTICAL CLEARANCE FROM GAS PIPE.
  - 14 PROVIDE 1-4" COATED STEEL CONDUIT SLEEVE CROSSING PIPELINE FOR ROUTING 2"EC SERVING RR/C PANEL FROM PANEL MDP. MAINTAIN MINIMUM 24" VERTICAL CLEARANCE FROM GAS PIPE.
  - 15 ROUTE CONDUIT THROUGH SLEEVE FOR CROSSING PIPELINE. SEE SHEET E-3 FOR SLEEVE LOCATION.
  - 16 ROUTE LIGHTING CIRCUITS THROUGH CONTACTORS IN MUSCO CONTROL PANEL AND THEN TO CIRCUIT BREAKERS IN POWER PANEL.

DOMINION ENERGY WORK ORDER NUMBERS:  
10049974: MAIN SERVICE (ENCLOSURE)  
10174574: FOR PARKING LOT LIGHTS

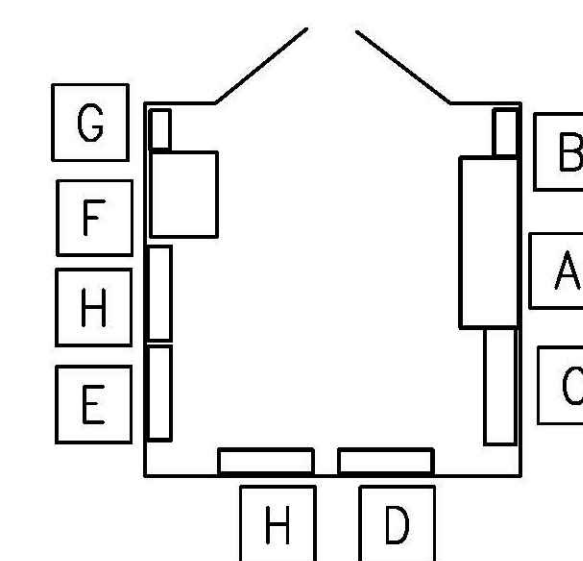

**ELEC EQUIP ENCLOSURE**  
SCALE: 1/4" = 1'-0"

## ELEC ENCLOSURE NOTES

- ☐ A POWER CO CT CABINET.
- ☐ B POWER COMPANY METER
- ☐ C PANEL MDP.
- ☐ D PANEL MPFL1.
- ☐ E PANEL BB.
- ☐ F TRANSF. T-RR/C.
- ☐ G TRANSF DISCONNECT.

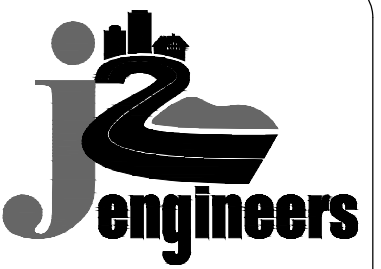

**J2 Engineers, Inc.**  
4080 Lafayette Center Drive  
Suite 330  
Chantilly, VA 20151

703.361.1550 (office)  
703.361.1566 (fax)  
[www.j2engineers.com](http://www.j2engineers.com)

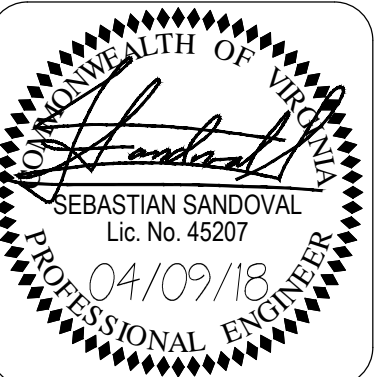

PLAN# STPL-2016-000X  
DATE: JANUARY 2016  
CONTOUR INT. = N/A  
SCALE: 1" = 50'

PLAN DATE
01/28/16
06/15/16
06/28/16
02/27/17
05/17/17
10/06/17
04/09/18

*ELECTRICAL - SITE PLAN*

**SITE PLAN**

**MOOREFIELD STATION NEIGHBORHOOD PARK**

DULLES ELECTION DISTRICT  
LOUDOUN COUNTY, VIRGINIA

[illegible]

SHEET  
**50(E-2)**

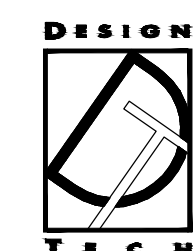

**DESIGNTECH INC.**  
Engineering Services  
10410 Kensington Parkway, Suite 200  
Kensington, MD 20895  
Phone: 301 949-2068 • Fax: 301 949-2069  
Project #:



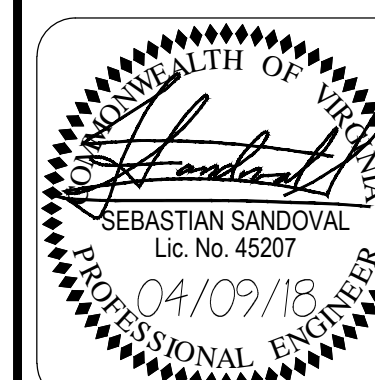

PLAN# STPL-2016-00XX  
DATE: JANUARY 2016  
CONTOUR INT.= N/A  
SCALE: 1" = 50'

PLAN DATE
01/28/16
06/15/16
06/28/16
02/27/17
05/17/17
10/06/17
04/09/18

*ELECTRICAL - SITE PLAN*  
**SITE PLAN**  
**MOOREFIELD STATION NEIGHBORHOOD PARK**  
DUILLES ELECTION DISTRICT  
LOUDOUN COUNTY - VIRGINIA

[illegible]

SHEET  
**51 (E-3)**

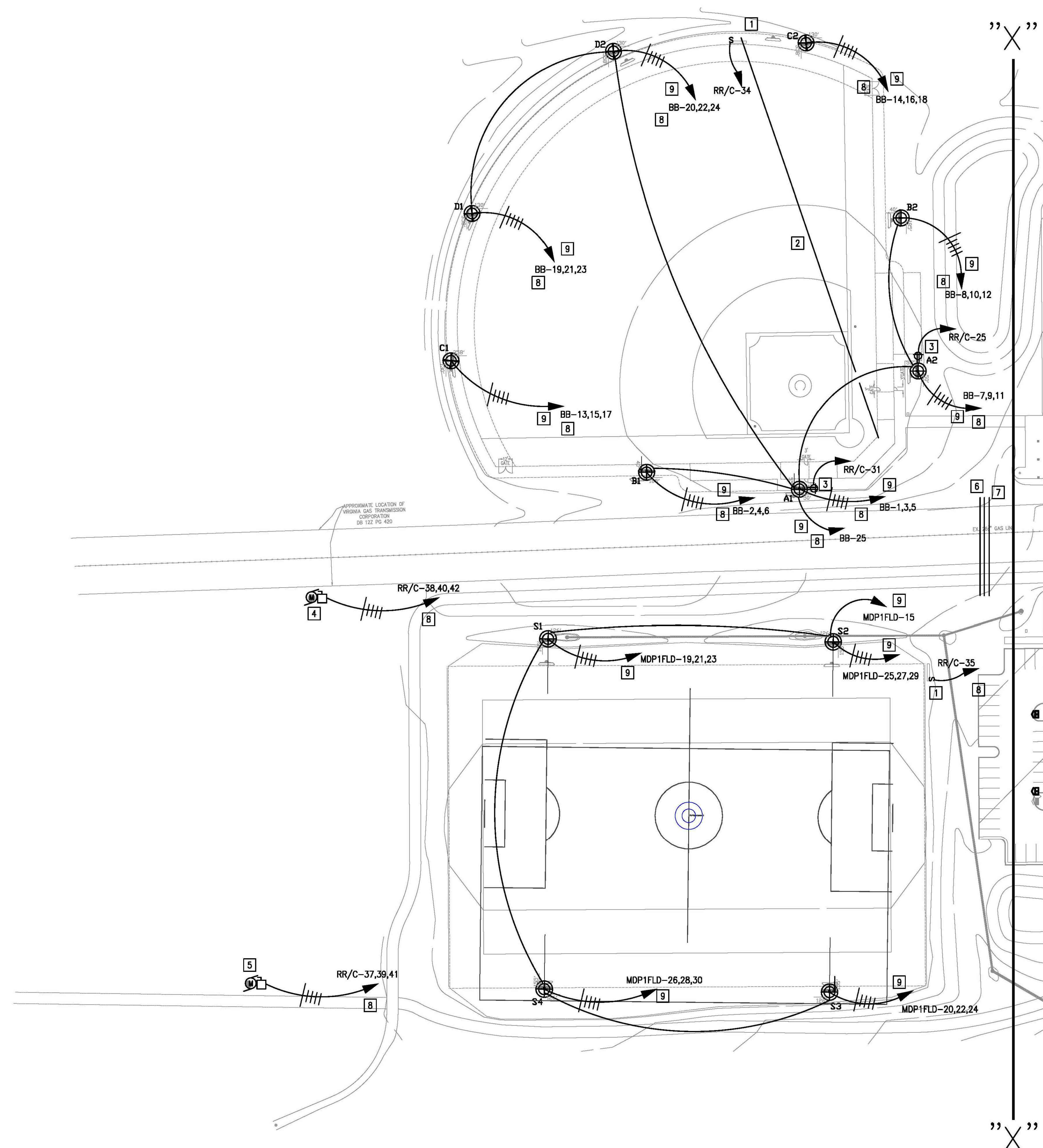

**SITE PLAN—ELECTRICAL**  
SCALE: 1" = 50'-0"

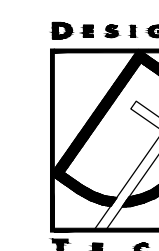

**DESIGNTECH INC.**  
Engineering Services  
10410 Kensington Parkway, Suite 201  
Kensington, MD 20895  
Phone: 301 949-2068 • Fax: 301 949-2069  
Project #: