



Loudoun County, Virginia

Division of Procurement
One Harrison St, SE, 4th Floor
Leesburg, Virginia 20175

April 8, 2021

NOTICE TO BIDDERS

ADDENDUM NO. 4

RFQ 372783

The following changes and/or additions shall be made to the original Invitation for Bid (IFB) RFQ 372783 Loudoun County Metro Parking Garages Fare Collection & Improvements. Please acknowledge receipt of this addendum by signing and returning with your bid.

1. The purpose of this addendum is to respond to questions and modify contract documents.

2. ***SPECIFICATION ITEMS:***

ITEM NO. 01: TABLE OF CONTENTS

DELETE SECTION 09 96 00 – HIGH PERFORMANCE COATINGS

ITEM NO. 02: SECTION 011100 – SUMMARY OF WORK

Paragraph 1.1

REVISE reference to Croson Avenue to read Croson Lane.

3. ***DRAWING ITEMS***

ITEM NO. 01: CV06.0001 – UTILITY PLAN

ADD data conduit between fare collection island and the parking garage per attached revised sheet.

ITEM NO. 02: PKE101 – ELECTRICAL SITE PLAN

ADD note referencing camera equipment schedule per attached revised sheet.

ITEM NO. 03: PKE102 – BOLLARD AND SIGNAGE DETAILS

ADD Security Camera Schedule and associated notes per attached revised sheet..

ITEM NO. 04: E101 – ELECTRICAL SITE PLAN

REVISE detail reference 2/E102 to read 2/E201.

ADD data conduit between fare collection island and the parking garage per attached revised sheet.

ITEM NO. 05: E201 – ELECTRICAL LEVEL 1 POWER PLAN

REVISE detail reference 2/E102 to read 2/E201.

ADD data conduit between fare collection island and the Telecom Room in the parking garage per attached revised sheet.

Prepared By: s/Christopher Bresley, CPPB Date: 4/1/2021
Contracting Officer

Acknowledged By: _____ Date: _____

ATTACHMENTS:

Attachment 1: Revised Plan Sheet CV060001
Attachment 2: Revised Plan Sheet PKE 101
Attachment 3: Revised Plan Sheet PKE 102
Attachment 4: Revised Plan Sheet E101
Attachment 5: Revised Plan Sheet E102
Attachment 6: Specification 11 12 00 – Parking Access and Revenue Control System

BEGIN QUESTIONS

Q1: Reference: Table of Contents. The table of contents listed Division 09-Finishes "High-Performance Coating" however the technical specification is missing or it's not included on the documents, if this is required, please provide us a quantity or location where is this needed and provide us a technical specification.

A1: Please refer to Addendum Item above.

Q2: I am trying to see if the parking equipment/technology for this project has already been selected or if it is part of the RFQ for the construction contractor.

A2: The parking technology equipment required for this project is identified in the specifications. Please refer to IFB Paragraph 19.28 if considering a substitution request.

Q3: Ashburn Garage: Please provide light and pole schedule reference E101

A3: Refer to revised sheet E101. Contractor to coordinate with county on available pole and light fixture during the pre-construction meeting.

Q4: Loudoun Gateway: Drawing E101 refers to details on E102 which is not included. Please confirm whether or not E201 is the correct drawing.

A4: E102 is not part of the set. See Addendum Item above for clarification.

Q5: Confirm that this lot will connect to the existing WMATA's PARC System Severs as described below and interface to the existing AMI PARCS Software.

A5: Refer to A6 and A7 items below.

Q6: Page 11 1200-3, B. Description, 2., I): The Parking Lot's PARC System equipment, including all I/O's and associated Amano Software Interface shall be connected to WMATA's Parking Operations Control Center and Facilities Controller Servers through WMATA's Metro NET located at 600 Fifth Street, N.W., Washington D.C. and back-up Facilities Controller Servers

- Confirm that this lot will connect to the existing WMATA's PARC Command Intercom Media Servers as described below and interface to the existing Command Center Intercom System

A6: Yes.

Q7: Page 11 1200-3, B. Description, 2., N): Provisions and full compatibility with

installation of the In-Lane VOIP Intercom and Credit Card Readers

- Confirming this will interface to the existing PARCS System per WMATA's Standards.

A7: Yes.

Q8: 01 General: Location for Ashburn Station South address on drawings is Croson Lane, in specification book – summary of work page 1.1 Croson Avenue.

A8: Croson Lane is correct. See Addendum Item above.

Q9: 01 General: Will storing of equipment/ material Laydown area within garage?

A9: Yes. Location and access will be discussed at the pre-construction meeting. Contractor is responsible to provide the necessary security, protection and is to restore area back to original condition prior to final completion.

Q10: 01 General: Projects to be completed simultaneously? Construction start time of both garages?

A10: Yes, this is one project. Work at both sites will run concurrently.

Q11: 01 General: Single (1) Super needed for both locations?

A11: County assumes one (1) single superintendent only.

Q12: 01 General: QC manager required separate from superintendent?

A12: Yes.

Q13: 01 General: Confirm VDOT permit of any kind is not necessary.

A13: Contractor to obtain ALL permits, if any are required.

Q14: 01 General: Confirm single phase project, will have open garage to perform work- both locations

A14: Confirmed.

Q15: 01 General: Wage scale project?

A15: No.

Q16: 03 000 Concrete: Confirm detail 2/S401 -epoxy injection concrete- for each location (designated "E" drawing S1010 detail) 6ft of applicable epoxy injection to be

completed per location.

A16: The work scope is clearly shown on Detail 2/S401 and encompasses the entire length of a crack. Crack lengths will likely vary by location, but anticipated lengths can be field verified.

Q17: 03 000 Concrete: Confirm (23) locations to be epoxy injected.

A17: Locations of cracks to be epoxy injected are indicated on the drawings. Opportunities for site visits were provided to observe exact locations.

Q18: 03 000 Concrete: Confirm amount of bollards to have sealant removed.

----- Drawings S101 Note for detail 1/S402 (TYP) "Remove existing sealant where applicable" < How many locations; Linear footage of removal and new sealant? All floors

A18: Cove joints will be provided at all sign and bollard base plate locations. Sealants will be removed at all locations. All existing cove joint sealants will be removed. Some base plates do not have existing cove joints. Base plate dimensions are provided. Base plate locations are provided. Quantities of specific work items can be determined with information shown on plans.

Q19: 03 000 Concrete: Confirm scope of work for 3rd party testing to be responsible by General contractor. See excerpt below

-----Drawing S102, General Note #2 "Prior to the start of construction, all areas designated for repair shall be sounded by the contractor in presence of engineer. All delaminated areas paint marked by contractor" < What is the additional extent of work from what is detailed within drawings? See cut photo from S103, general notes 1&2.

GENERAL NOTES:

1. LOCATION, EXTENT, AND SIZE OF DELAMINATIONS, SPALLS AND PATCH AREAS SHOWN ON PLANS ARE APPROXIMATE. ALL AREAS SHALL BE EXACTLY LOCATED BY THE CONTRACTOR IN THE FIELD IN ACCORDANCE WITH NOTE #2 BELOW. ADDITIONALLY, AREAS OF CONCRETE REMOVAL/REPLACEMENT MAY BE INCREASED/DECREASED AS DIRECTED BY THE ENGINEER.
2. PRIOR TO THE START OF CONSTRUCTION, ALL AREAS DESIGNATED FOR REPAIR SHALL BE SOUNDED BY THE CONTRACTOR IN THE PRESENCE OF THE ENGINEER. ALL DELAMINATED/SPALLED AREAS SHALL BE PAINT MARKED BY THE CONTRACTOR AS DIRECTED BY THE ENGINEER IN THE FIELD.

A19: The term "Engineer" on the drawings refers to the designated field representative of DESMAN; not the third-party testing agency. The scope of repair work is as indicated on the bid drawings; no additional work from what is detailed on the drawings is intended.

Q20: 03 000 Concrete: Confirm all additional work not shown on contract documents will

be reconciled with change order proposal (General note 1&2 above)

A20: No work other than that detailed on the drawings is anticipated.

Q21: (05 000): Spec for handrail- Drawing CV05.0002, Detail shown below. Specification for handrail is not specified in detail.

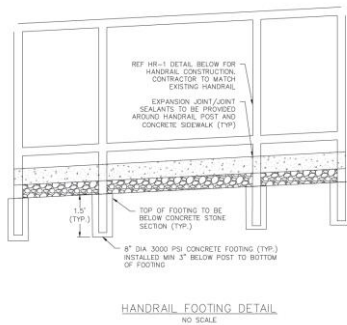

A21: Detail referenced HR-1 detail found on sheet CV05.0002 and shall be in accordance with the requirements of the VDOT Road and Bridge Specifications.

Q22: (05 000): Detail for handrail installation shows railing mounted in footing, (Shown above); Existing railing is surface mounted- (Shown below) Please advise on configuration.



A22: Install as shown in detail with footing.

Q23: (05 000): Confirm approximately 50 bollards per level to be resealed per note S103 typical, shown below.

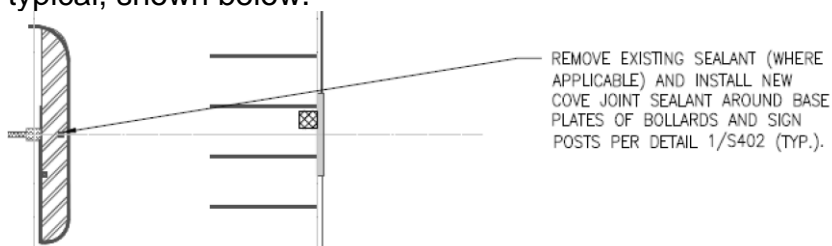

- A23: Quantities of specific work items can be determined by items shown on plan.
- Q24: (09 000): High performance paint- No spec section, listed in table of contents - Where does this scope apply?
- A24: Refer to Response A1.
- Q25: 11 12 00 Parking Access & Revenue: What is the extent of the work by others? Where is system server location? 1.2 Summary; D Work by others.
- A25: See Section 1.2.B.2.k of Specifications Section 11 12 00 for a description of server locations.
- Q26: 11 12 00 Parking Access & Revenue: Confirm that this lot will connect to existing WMATA PARC System servers as described below and will interface to existing AMI PARCS Software (Page 11.12.00-3, B. Description, 2.I)
- a. "The parking lots PARC system equipment including all I/o and associated Amano software interface shall be connected to WMATA parking operations control center facilities controller servers through WMATA MetroNet located at 600 Fifth street, N.W. Washington DC and back up facilities controller servers"
- A26: Correct.
- Q27: 11 12 00 Parking Access & Revenue: Confirm that this lot will connect to existing WMATA PARC command intercom media servers and interface to existing command center intercom system. Described Page 11.12.00-3, B. Description 2.N)-
- a. "Provisions and full compatibility with installation of the in lane VOIP intercom and credit card readers (Confirming this will interface to existing PARCS system per WMATA standards"
- A27: Correct.
- Q28: 11 12 00 Parking Access & Revenue: Where there be any work that extends over/ below Dulles greenway (highway). Will scope of work for installation of PARCS cabling extend past existing handhold?
- A28: For the location of the fiber patch, see Section 1.2.C.4 of Specifications Section 11 12 00. Metro Rail Station Communications room is located between the eastbound and westbound lanes of the Greenway. Per the plans, existing conduit pathways are provided for cabling from the fare collection island to the Metro Rail Station.
- Q29: 11 12 00 Parking Access & Revenue: Please provide specification for PARCS cabling that will be accepted by WMATA –
- A29: For fiber optic cabling, see Section 1.2.B.2.f of Specifications Section 11 12

00.

Q30: 11 12 00 Parking Access & Revenue: Confirm specific fiber optic cable to be utilized is BERTEK cable- model number OPAD 12B024-012EB3010/25-12AB0403

A30: For fiber optic cabling, see Section 1.2.B.2.f of Specifications Section 11 12 00, as revised in Addendum 4.

Q31: 11 12 00 Parking Access & Revenue: Confirm all programming for final system tie-in is proprietary system

A31: All installations including system tie-in must be compatible to WMATA's existing PARCS and video intercom systems.

Q32: 11 12 00 Parking Access & Revenue: Confirm SmartTrip system utilized by WMATA is proprietary system

A32: For a description of WMATA SmartTrip system, see Section 2.12 of Specifications Section 11 12 00.

Q33: 11 12 00 Parking Access & Revenue: Confirm SmartTrip cabling to be Beldon 88778 or Beldon 87778 model cable-

A33: See response to Question 30 above.

Q34: 11 12 00 Parking Access & Revenue: Where is the PARC system backup/emergency generator? Specification referenced- 11 12 00 1.2;B.2; g)

A34: For electric and power information, see Drawing E101.

Q35: 11 12 00 Parking Access & Revenue: Provide location of Facility Management System Server? (Is this the Bison Profab Conditioned traffic box shown PKE 101, Detail 3). Specification referenced- 11 12 00 1.2; B.2; k)

A35: The server location is clearly described in the referenced paragraph. It will be located inside the conditioned traffic box.

Q36: 11 12 00 Parking Access & Revenue: Specification referenced- 11 12 00 1.2; B.2; l) Provide location for splice for "WMATA Parking Operations Control Center" to tie in new PARC system. Will work extend to metro station located between Dulles greenway lanes?

A36: For the location of the fiber patch, see Section 1.2.C.4 of Specifications Section 11 12 00.

Q37: 11 12 00 Parking Access & Revenue: E101 Note 1. Provide location in existing metro

station for parking control wire to be spliced/ tied into from existing conduit

A37: For the location of the fiber patch, see Section 1.2.C.4 of Specifications Section 11 12 00.

Q38: 11 12 00 Parking Access & Revenue: Clarify voltage requirements for traffic control equipment/ PARC system

A38: Voltage needs for parking control equipment will vary depending on actual equipment selected. The General Contractor is expected to coordinate this.

Q39: 11 12 00 Parking Access & Revenue: Please confirm there are 600 locations per level, per picture cut shown below. Typical S103.

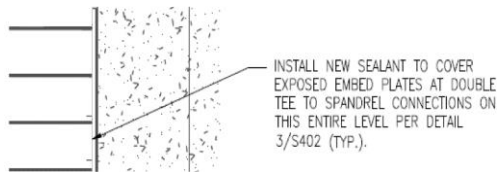

A39: Detail 3/S402 applies to all connection between double tees and perimeter spandrel panels on elevated levels 2 through 5.

Q40: 11 12 00 Parking Access & Revenue: Confirm note “replace spalled flange”, refers to single flange: per picture cut shown below. Typical S103

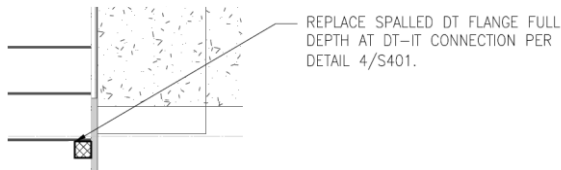

A40: The locations of full depth double tee flange repairs are shown on the plans and detailed in 4/S401.

Q41: 26 000 Electrical: Please provide specification for light pole to be installed at Croson lane garage

A41: Products are existing on site and ready to be installed. GC to coordinate with the County/Owner.

Q42: 26 000 Electrical: Will transformers or surge protectors of any kind be required?

A42: Transformers and/or surge protectors are not required, as noted in on the electrical drawings.

Q43: 27 000 Communications: High speed internet installed by owner- where does scope start and end? 11 12 00 1.2D

- A43: WMATA is bringing high speed internet to the patch panel described in paragraph 1.2.C.4 of the Specification Section 11 12 00.
- Q44: 27 000 Communications: Confirm specific communication cable to be utilized.
- A44: For fiber optic cabling, see Section 1.2.B.2.f of Specifications Section 11 12 00.
- Q45: 28 000 Security: Confirm scope of work for security cameras. Is contractor supply/ install? Or will contractor be responsible for tying in security system?
- A45: Refer to Drawings PKE101 and PKE102 as revised in Addendum#4.
- Q46: 28 000 Security: Provide security contractor for WMATA security,
- A46: Security System (Cameras) are maintained by Loudoun County. Security Vendor is:
- Next Generation Security Concepts, Inc
21 Main Street
Round Hill, VA 20141
Phone: [540-338-8160](tel:540-338-8160)
Fax: 703-935-2338
- Q47: 28 000 Security: Security system proprietary?
- A47: Security Camera equipment specified in Addendum 4 matches the camera equipment in the parking garage. No substitutions.
- Q48: 28 000 Security: Provide full, concise scope of security camera show on traffic parking equipment
- Q48: Refer to response to Question 45 above.
- Q49: 32 000 Earth: Water access on site? Water supply by client/ Loudoun County?
- A49: Yes, will be provided via hose-bib. Location and access will be discussed at the pre-construction meeting. Contractor is responsible restore area back to original condition prior to final completion.
- Q50: 32 000 Earth: Will electrical/ power be provided on site or does contractor need to provide generator
- A50: Yes, will be provided via power outlets. Location and access will be discussed at the pre-construction meeting. Contractor is responsible restore area back to original condition prior to final completion.

Q51: 32 000 Earth: Confirm existing curb and gutter will not widen with installation of new equipment pad.

a. To be more specific, existing lane will not widen beyond existing curb? New construction of curb will be in existing place?

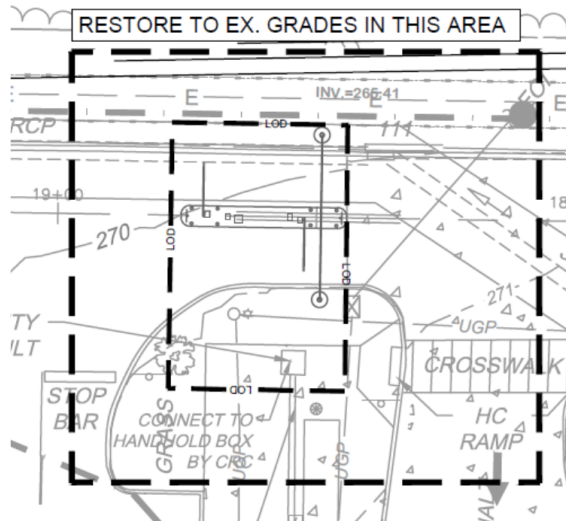

A51: Confirmed. The existing curb and gutter on the north and south drive isles will remain in place. Resulting lanes width resulting from construction of the island shall be provided as specified on sheet CV01.0001.

END QUESTIONS