

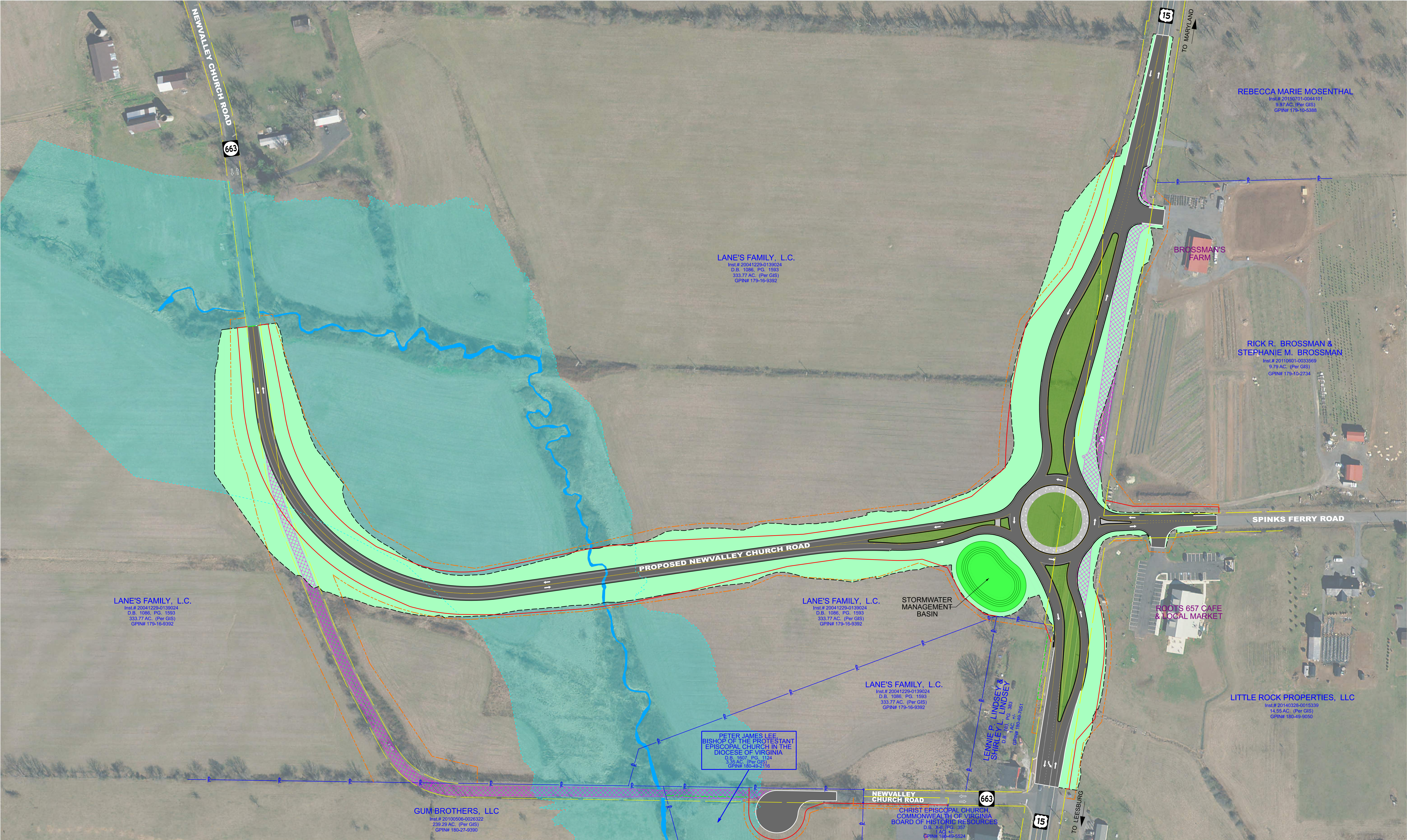

Aerial Overview

U.S. Route 15 and Spinks Ferry Road Roundabout, Loudoun County, Virginia



Project Location

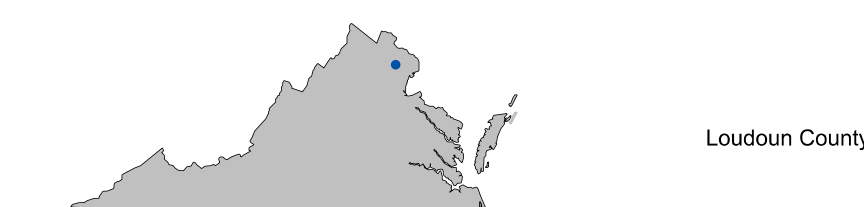

North Arrow & Scale

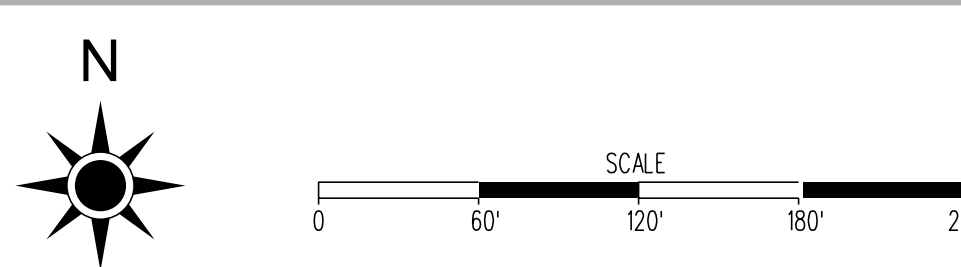

Legend

- Proposed Road
- Concrete Truck Apron
- Concrete
- Demolition of Pavement
- Proposed Stormwater Management Basin
- Grass
- Grass Median
- Flood Plain
- Stream
- Existing Right of Way
- Existing Property Line
- Proposed Right of Way Line
- Proposed Temporary Construction Easement Line
- Proposed Permanent Easement Line
- Grading Limits

Contact Information

Joseph Powers, P.E.
Project Manager
Loudoun County Department of Transportation and Capital Infrastructure
P. O. Box 7500
Leesburg, Va 20177
Comments may also be sent to:
xxx@loudoun.gov